

# Casement Windows

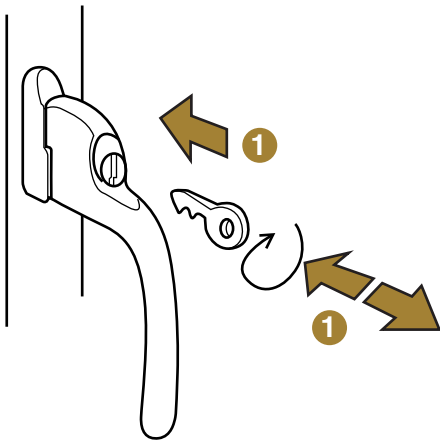

## Operation Guidelines

**1** To open the window using the keys provided (if applicable) unlock the handle . . .



Your windows may have been fitted with different types of hinges depending on the application – some hinges have an emergency exit (egress) or easy-clean function.

Please refer to your installer for the specific instructions for your hinge.

Please ensure that when you leave your house you close the window and lock with the key.

Then remove the key and place it in a safe location, away from the window.

**2** . . .then release the catch by depressing the button, and turning the handle.

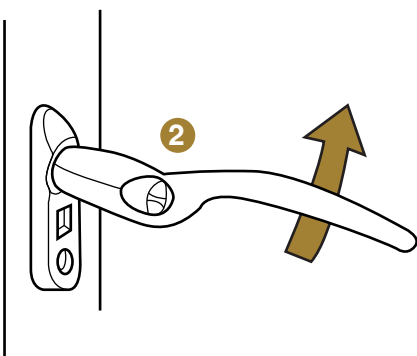

To close the window - fully close the window, turn the handle and lock using the key.